

REKANIZE REVIVER

Easy. Fast. Clean.

Cleanse and revive your footwear.

1 FEATURES

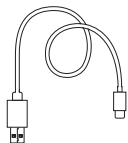

USB-C Cable

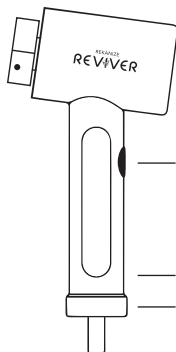

Power Button /
Speed Control

Press 1x - Turn ON +
Low Speed
Press 2x - High Speed
Press 3x - Turn OFF

Indicator Light

USB Cap

Turn towards the
left to remove.

BRUSHES

2

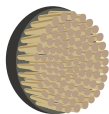

1. Soft Brush

Expel debris, dust,
and dirt before
cleansing.

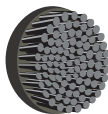

3. Sole Brush

Removes dirt from the
crevices and surface of
the sole.



2. Scrub Brush

Works into the body
of the sneaker to
cleansing and purify.

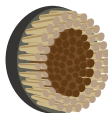

4. Suede/Nubuck Brush

Uplifts the fibers to
restore their original
texture.

Note: Some bristles may dislodge from brushes during early stages of use. Caution: Keep out of reach of children.

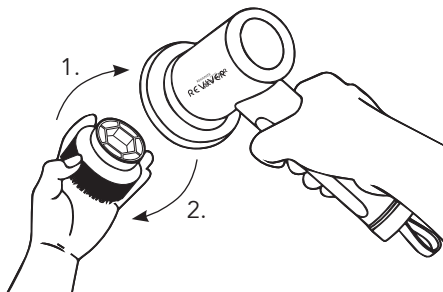

Note: Below is the average process for most sneaker materials. You may need to switch between brush 1 & 2, and speed 1 & 2, depending on the material. User discretion is advised.

1. Install Soft Brush 1.

- Press the power button to turn it ON and activate slow speed. The indicator light will turn **green**.
- Slowly glide the brush over the entire sneaker to remove dirt.

2. Install Scrub Brush 2.

- Squeeze a few pumps of Lather* or your choice of cleaning solution on the sneaker body.
- Press the power button 2x to activate high speed. The indicator light will turn **blue**. Slowly glide the brush to work in Lather. Add Lather when necessary.

1. Attach Brush

- Make sure the Reviver is OFF.
- Align the back of the brush with the hexagon shape attached to the front of the machine interface.
- Push until it snaps on.

2. Remove Brush

- Make sure the Reviver is OFF.
- Hold the handle while pulling the brush away from the machine.

Note: Do not push brushes deeply into the sneaker during use. Allow the machine to do the work.

3. Install Sole Brush 3.

- Squeeze a few pumps of Lather* onto the sole. Press the power button 2x to activate high speed. Slowly glide the brush over the entire sole.

4. Wipe excess Lather off with a microfiber cloth* then air dry.

5. For Suede/Nubuck, lightly use Brush 4 on low speed to break up dirt and revive the material to a plush state. Make contact with the firm bristles first then finish with the outer bristles in a circular motion.